

CATEGORY BUILDING SYSTEMS



PRODUCT / TECHNOLOGY



Scan QR Code for
Technology Detail

MAGICLITE HOUSE

Alternative to conventional bricks/blocks masonry wall



Scan QR Code for
Video

CONTACT DETAILS

M/s Magicrete Building Solutions Pvt.Ltd.

Contact Person: Shri Siddharth Sharma

Address: -702 B, 22 Business Point, S V Road,
Andheri West, Mumbai, 400050

E-mails: Siddharth.sharma@magicrete.in

Mob: 9967870753



BRIEF

MagicLite ALC Wall Panels are reinforced with corrosion-protected steel, making it a lightweight yet heavy-duty product. With great success in global markets, the ALC Wall Panel technology offers durable & high-quality construction in the shortest possible time.

It has the high thermal rating in the industry (K-value: 0.16). Its cellular structure provides a well-insulated interior, keeping indoor cool in summer & warm in winter. According to some studies, it is found to have conserved up to 30% in air-conditioning bills.

MagicLite Panels are highly resource-efficient, ensuring low environmental impact. The panels have close air pockets that result into excellent sound insulation, adequately suppressing the outside noise. In addition, its 4-hour fire rating allows for thinner wall sections, thereby increasing floor space for the end-user. They come in full height lengths (from floor to ceiling) with varied thicknesses and are 600 mm wide.

The reinforcement in the panels provides additional flexural strength to the product, and hence even larger heights, there is no issue of deflection, warping, buckling effect.

Construction cost is mainly bifurcated into two parts: Material Cost and Labour Cost. The best option for budget homes is to reduce the labour cost by utilizing techniques that can reduce the project timelines. Trying to reduce the material cost might have an implication on the quality.

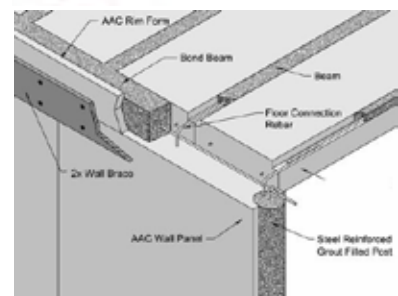

SALIENT FEATURES

- Thermally Insulated, Fire Resistant, Earthquake Resistant, Noise Pollution Resistant, And Water Resistant.
- Green Building material with High Strength.
- Resource efficient, about 70% reduction in raw material usage.
- No need for plastering and curing at site.
- Excellent thermal efficiency about 30% energy saving.
- High acoustic insulation with a sound reduction index of more than 40 db.
- Low manpower requirement, can be installed by Semi-skilled workers.

ECONOMIC ASPECTS

- Reduced manpower requirements.
- Resource and Time efficient.



SUSTAINABILITY ASPECT

- MagicLite Panels are Recyclable, inert & non-toxic.
- High Energy saving.
- Excellent life-cycle cost.
- Supports LEED credits.

SUITABILITY AND AVAILABILITY

- Suited for all weather conditions.
- ALC Wall Panel technology offers durable & high-quality construction in the shortest possible time.

LIMITATIONS, IF ANY

- MagicLite House can be used for Load Bearing Structures of not more than G+2.

MARKET LINKAGES

- Available pan India.



MAJOR PROJECTS

- L&T Constructions, Godrej, Mahindra,
- Lodha, Alembic, Advent Construction Ltd.,
- Kalpatrau Puranics, Global Warehouse Solutions, Panoli intermediates.

CERTIFICATION/INDIAN STANDARD/ENDORSEMENT

- Yet to be certified

