

Area of Site=1.85 Acre

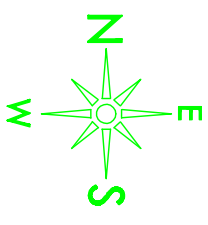

- Septic Tank
- UG Water Tank
- Recharge Pit

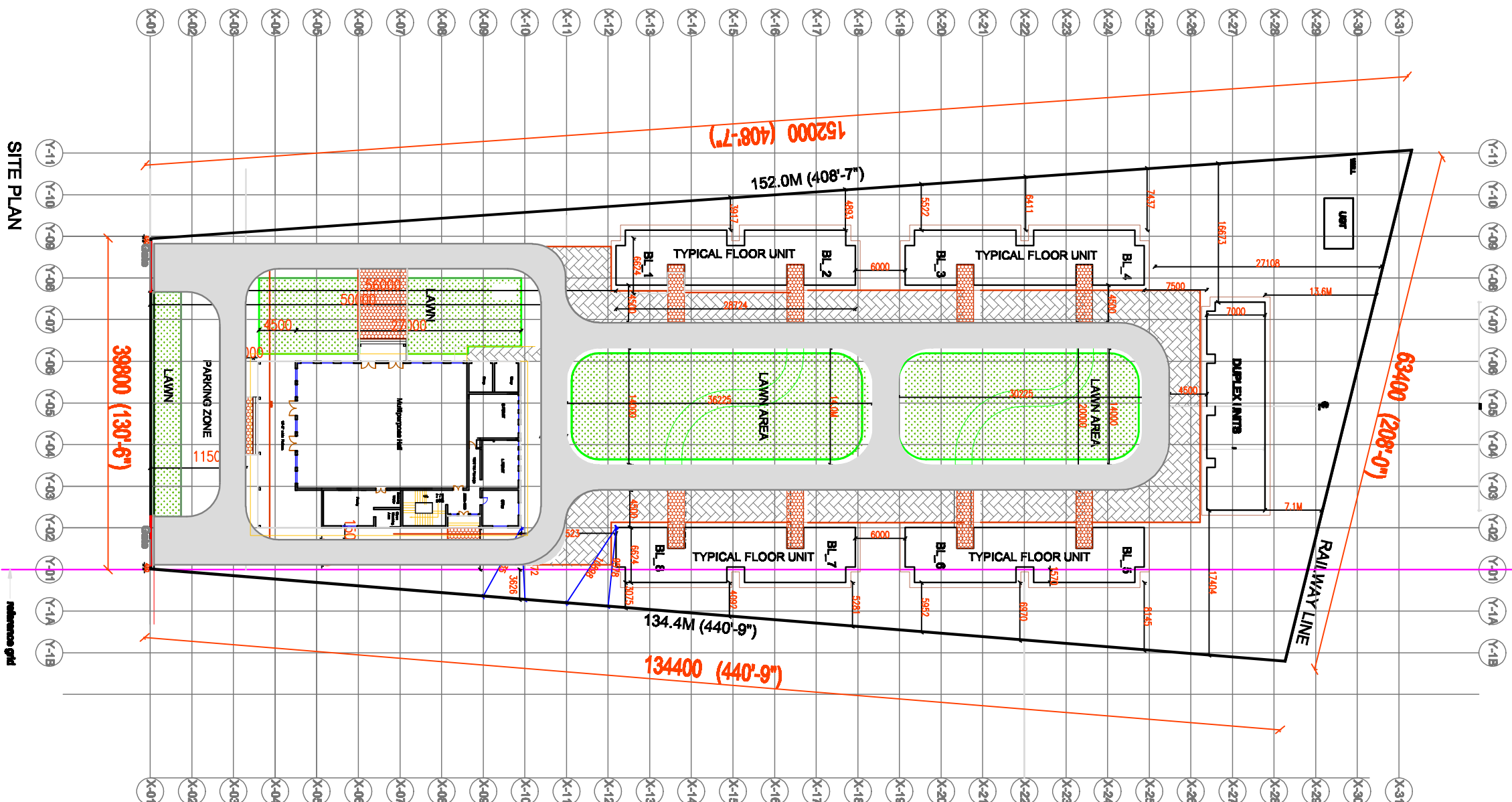

SITE PLAN

ROAD&PAVEMENT

PROJECIT
Proposed Demonstration Houses & Com.Center at Saraswathi Nagar of Chowtapalem Village, Venkatachalam Mandal,SPS Nellore District.

DRW/TITLE
SITE PLAN

DRW/NO.
LP_03

NORTH

DATE
SCALE
REVISIONS



ENGINEER
ARCHITECT
PLANNING